

## Product Guide

**PA0929** 2-Way 165mm (6.5") 50W Active Wall Speakers White (pair)

**PA0930** 2-Way 165mm (6.5") 50W Active Wall Speakers Black (pair)



# 165mm (6.5") 50W Active Wall Speakers

- ✓ Ideal for music sound reinforcement.
- ✓ Aluminium grille and bracket.
- ✓ In-built amplifier for easy integration.
- ✓ Easy to install, quick adjust bracket.
- ✓ Outstanding sound reproduction.
- ✓ Outstanding sound reproduction.
- ✓ Great for bars, cafes, boutiques etc.
- ✓ Includes two right angle RCA adaptors.



## Application

These high power music speakers feature exceptional sound quality for professional sound reinforcement. Great for classrooms, lecture theatres, boardrooms, cafes, function areas, pubs, boutiques etc.

The ported bass reflex enclosure produces outstanding sound reproduction. This system can be employed anywhere quality foreground or background audio is required.

## Installation Guidelines

System comprises of one active speaker with inbuilt stereo amplifier and one passive speaker which is powered from the active speaker.

The bass drivers they feature a stylish contoured profile and quick mounting bracket which virtually disappears once mounted.

An in-built amplifier allows easy integration into existing systems with only line level signal required for operation.

Rear mounted volume, bass and treble controls. RCAs provide easy connection to existing audio sources.

## About Redback® Speaker Drivers

Each custom designed speaker has been specifically engineered to ensure a wide frequency range and dispersion angle, plus a high sound pressure level (SPL) ensuring excellent music and speech intelligibility.

Redback® drivers exhibit optimum frequency response and efficiency for BGM and paging applications.

## Testing

Redback® drivers are subject to strenuous factory testing reducing the risk of unit failure or performance reduction over time. Each driver has a power rating well above the max output of the internal amplifier, ensuring reliable operation and excellent longevity.

## Product Guide

**PA0929** 2-Way 165mm (6.5") 50W Active Wall Speakers White (pair)

**PA0930** 2-Way 165mm (6.5") 50W Active Wall Speakers Black (pair)

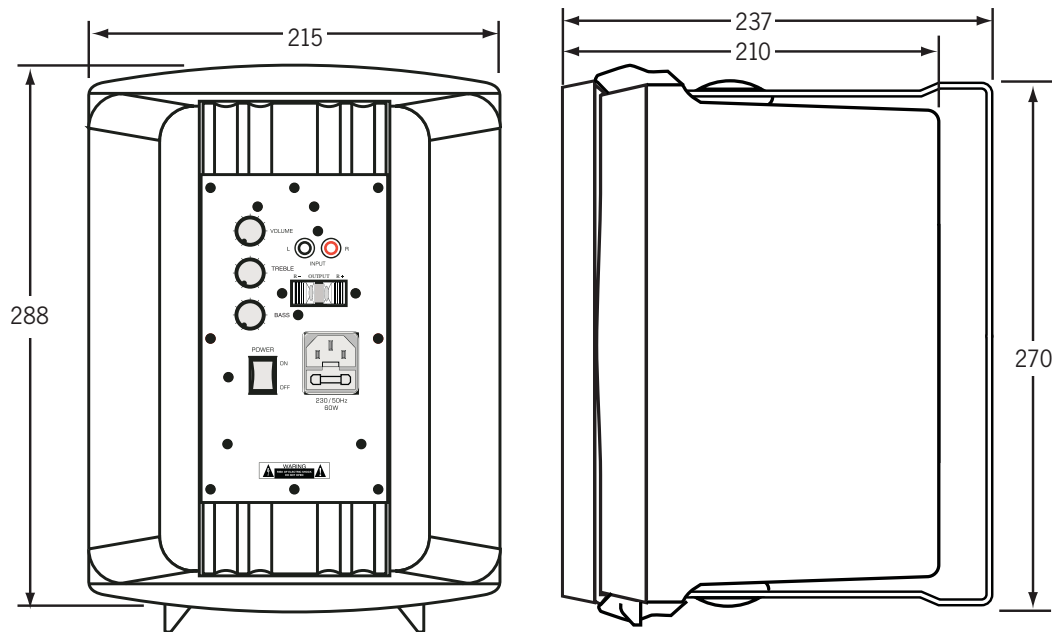

### Specifications

#### Electrical

Rated power:	50W Max
SPL 1W @ 1m:	85dB @ 1kHz (+/- 2dB)
Frequency response:	70Hz-20kHz
Passive connection:	Spring terminals
Active connection:	RCA input, spring terminal output

#### Mechanical

Grille material:	Aluminium mesh
Driver construction:	Polypropylene
Mounting depth (from wall surface):	XXmm
Dimensions (mm):	288H x 215W x 242D
Active weight:	5kg
Passive weight:	4kg

#### Environmental

Operating temperature:	-10°C to +55°C
Relative humidity:	< 95%

### Frequency Response (SPL 1W @ 1m)

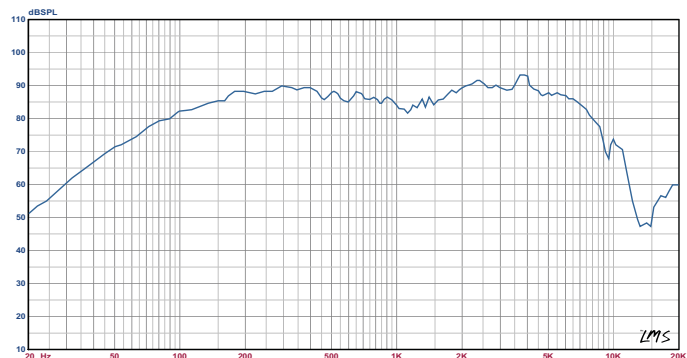

### Architect Specifications

#### PA0929

The speakers shall consist of active and passive units in a matching pair. The active unit shall feature an in-built 50 watt amplifier module fitted with stereo RCA input and spring terminal output connection for passive speaker connection. The active speaker shall power the passive speaker. The speaker shall offer an SPL of 85dB measured at 1kHz (1W/1m). The speaker driver shall be 165mm (6.5") polypropylene with accompanying dome tweeter for high frequency reproduction. The speaker shall be protected by an aluminium rust free mesh grille. The speaker units shall feature a low profile aluminium mounting bracket, powdercoated in white. This shall be secured via thumbscrews on the top and bottom of each unit. The speaker enclosures shall be neutral white RAL colour. The speaker shall be REDBACK C 0929.

#### PA0930

The speakers shall consist of active and passive units in a matching pair. The active unit shall feature an in-built 50 watt amplifier module fitted with stereo RCA input and spring terminal output connection for passive speaker connection. The active speaker shall power the passive speaker. The speaker shall offer an SPL of 85dB measured at 1kHz (1W/1m). The speaker driver shall be 165mm (6.5") polypropylene with accompanying dome tweeter for high frequency reproduction. The speaker shall be protected by an aluminium rust free mesh grille. The speaker units shall feature a low profile aluminium mounting bracket, powdercoated in white. This shall be secured via thumbscrews on the top and bottom of each unit. The speaker enclosures shall be black in colour. The speaker shall be REDBACK C 0930.