

DAYTONAUDIO 

LOW FREQUENCY DSP CONTROLLER

Model: DSP-LF

Quick Start Guide

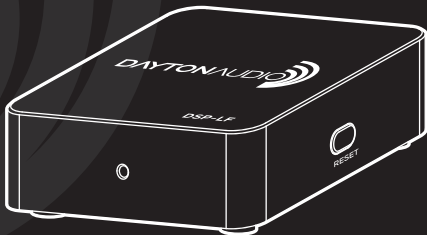

Functions

1. Line Out

Connect the DSP-LF to any subwoofer/bass shaker amplifier with an RCA input. Use the supplied 3.5mm to RCA cable.

2. Line In

Connect an audio source unit.

3. Power Input

Connect the DSP-LF to a power source with the included micro USB cable.

4. Reset

Hold the reset button for 3 seconds to reset the password on the DSP-LF to the default password, "0".

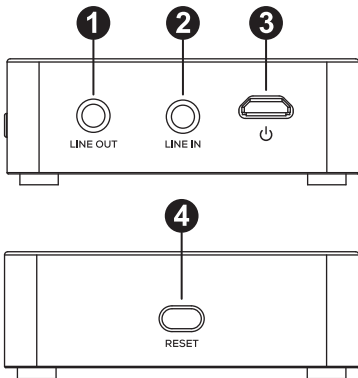

Connection



iOS/Android
device with
iWoofier app

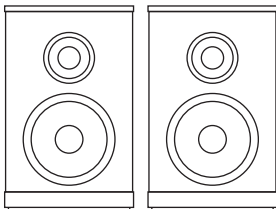

Existing amplifier or active speakers

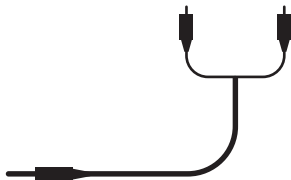
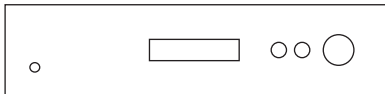

Included 3.5 mm - RCA cable

Room Tuning with iWoofers™ app

Room Correction Control

The iWoofers™ Pro app features automatic room correction. To begin, select “Room Correction” from the main menu. Select “Wizard” to begin the automatic correction process. Ensure that the gain knob is properly adjusted on the woofer and that the sub is not overdriven.

The iWoofers™ Pro app will begin by taking a near field measurement. Place the microphone as close as possible to the subwoofer and equal distance from the passive side. This can best be done by placing the microphone so that it is facing the side of the subwoofer halfway between the active and passive. After placing your mobile device in the proper location, select “Next” to begin the sweep. The subwoofer will now sweep through the frequency range. Once completed, you will be asked to add an additional response or sweep measurement or you may continue with setting up your subwoofer. It is important to remain as silent as possible during the sweeps.

Once you have obtained the desired sweeps select “No, Next” to continue to the next step. You will then be prompted to select the reference type for the room compensation, Boomy Region, Near Field or Linear. We recommend the “Boomy Region” selection since it maintains the high energy peaks of the low frequencies while creating a linear response for the mid-range. The near field option is ideal for users with poor mic tolerance as it measures relative SPL and only compensates for the room reflection and not the woofer/box itself. The Linear option creates a flat response curve.

After the desired option is selected, iWoofers™ will then instruct you to place the mic in your typical listening position. Once the mic is placed, click “Next”. The iWoofers™ Pro app will then proceed to sweep again. We recommend performing at least three response sweeps. Click “No, Next” when you have concluded your response sweeps and iWoofers™ will proceed to make the necessary adjustments to your subwoofers response.

Room Tuning with iWoofers™ app

Room Correction Control Continued

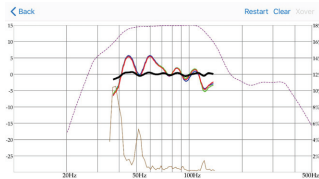
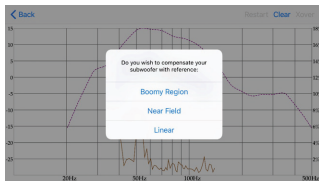
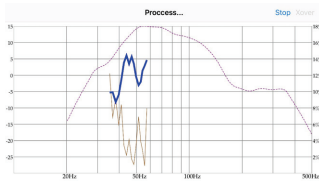

Room Tuning with iWoofers™ app

Main Menu Continued

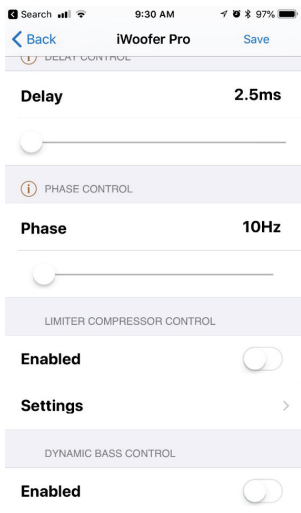
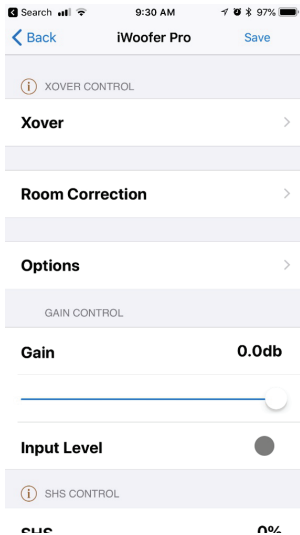

Crossover Control

The crossover control allows the user to control both the low-pass and high-pass filters by double tapping the curve, or pressing and holding it for more than one second. The curve can then be slid left or right to control the frequency from 20 Hz up to 500 Hz. The curve can also be slid up and down to control the order of the filter up to an 8th order or 48 db/oct filter.

To add a fully parametric equalizer (PEQ), select the "+" icon. Up to 25 bands can be added, to remove a band select the trash icon. Double tap or press and hold a band for more than one second to select it. Once selected, slide the band left or right to change the frequency and up and down to control the gain. You can also use two fingers in a zoom in or zoom out fashion to change the Q factor, or PEQ bandwidth.

iWoofers™ app

To download the iWoofers™ app and for more information on additional features of iWoofers™ and iWoofers™ Pro, please scan the QR code found here:



5-Year Limited Warranty

See daytonaudio.com for details



daytonaudio.com
tel + 937.743.8248
info@daytonaudio.com

705 Pleasant Valley Dr.
Springboro, OH 45066
USA

