

VL-8 P M

| HOLE No. | " X " | " Y " |
|----------|-------|--------|
| 1. | 49.1 | + 27.0 |
| 2. | 57.2 | + 26.4 |
| 3. | 52.3 | + 19.9 |
| 4. | 60.3 | + 18.2 |
| 5. | 54.6 | + 12.4 |
| 6. | 62.3 | + 9.7 |
| 7. | 55.8 | + 4.7 |
| 8. | 63.0 | + 0.9 |
| 9. | 55.9 | - 3.1 |
| 10. | 62.5 | - 7.9 |
| 11. | 54.9 | - 10.9 |

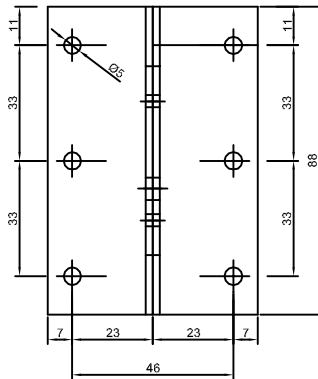

Left & Right bkt after Assy.

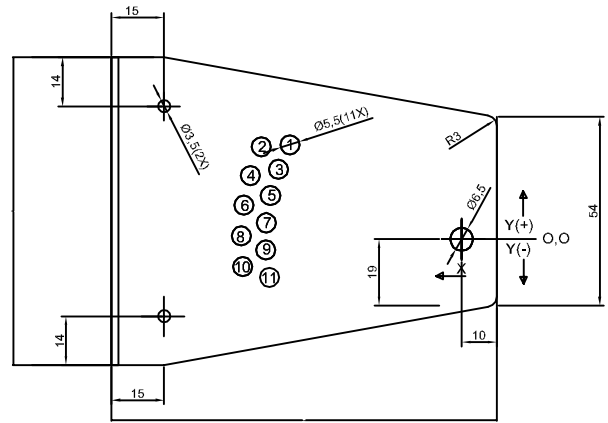
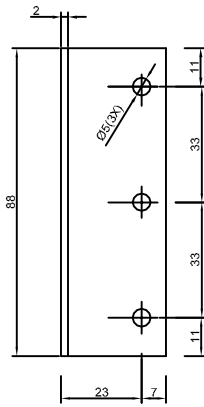
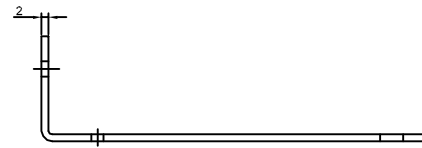

CABINET MOUNTING PLATE (RIGHT Side)
 Model : ALIGN - 400 PM. (POLE MOUNT BKT.)
 MAT: 2 m.m. M.S. PLATE
 FINISH: BLACK \\ WHITE POWDER COATED
 QTY: 1 no Per Set

SONODYNE 13 11 09

| HOLE No. | " X " | " Y " |
|----------|-------|--------|
| 1. | 49.1 | + 27.0 |
| 2. | 57.2 | + 26.4 |
| 3. | 52.3 | + 19.9 |
| 4. | 60.3 | + 18.2 |
| 5. | 54.6 | + 12.4 |
| 6. | 62.3 | + 9.7 |
| 7. | 55.8 | + 4.7 |
| 8. | 63.0 | + 0.9 |
| 9. | 55.9 | - 3.1 |
| 10. | 62.5 | - 7.9 |
| 11. | 54.9 | - 10.9 |

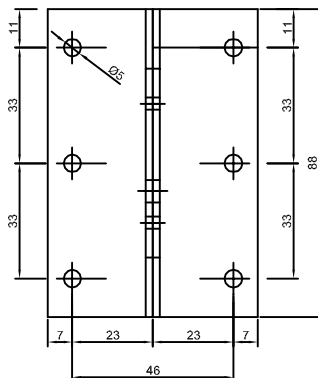
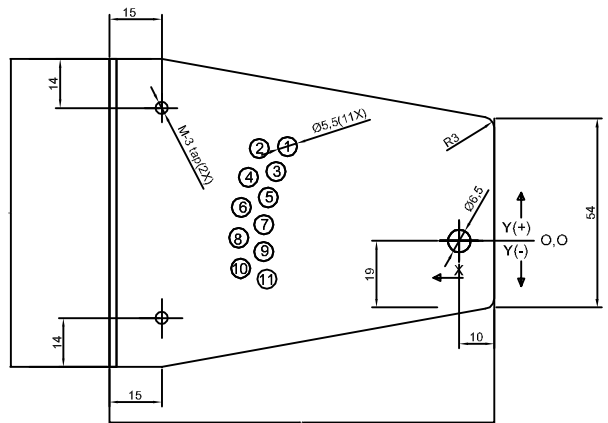
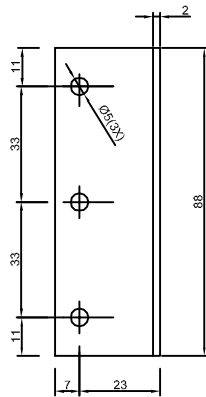

Left & Right bkt after Assy.



CABINET MOUNTING PLATE (Left Side)
 Model : ALIGN - 400 PM. (POLE MOUNT BKT.)
 MAT: 2 m.m. M.S. PLATE
 FINISH: BLACK \\ WHITE POWDER COATED
 QTY: 1 no Per Set

SONODYNE 13 11 09

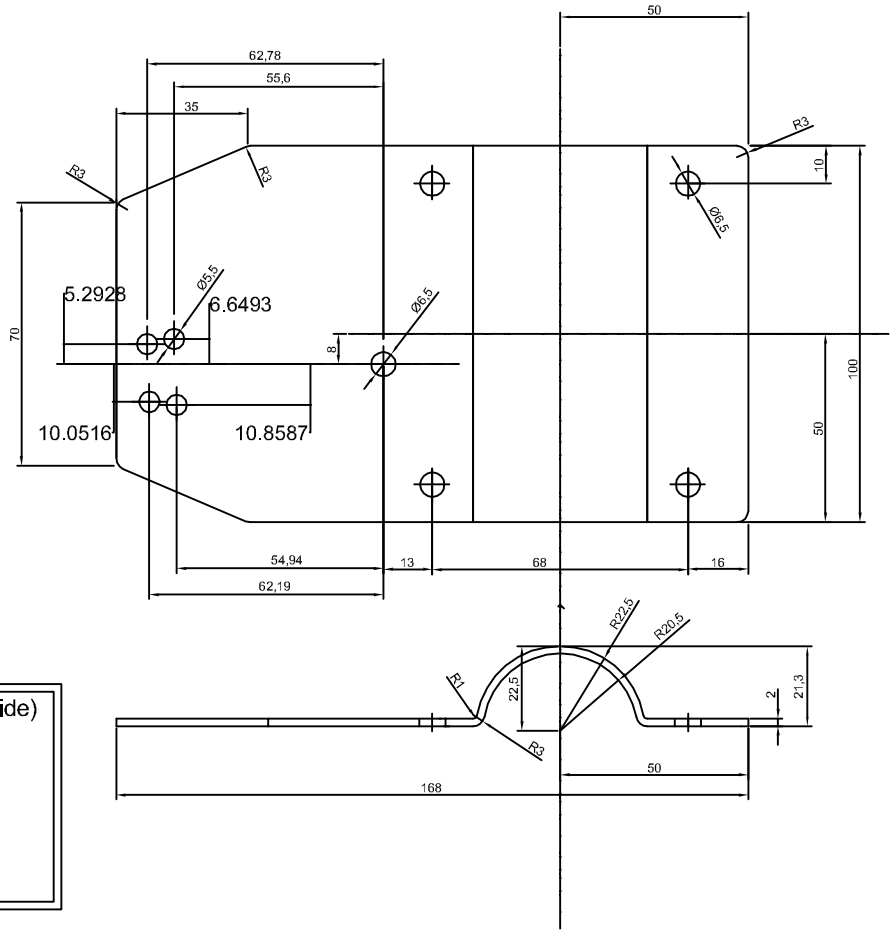
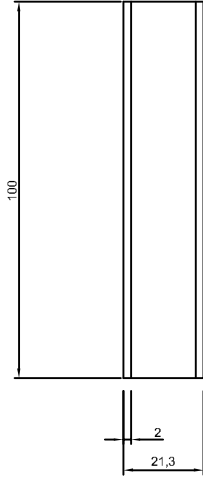

POLE PLATE for POLE MOUNT BKT.(Right Side)
 Model : ALIGN - 400 PM.
 MAT: 2 m.m. M.S. PLATE
 FINISH: BLACK \ WHITE POWDER COATED
 QTY: 1 no Per Set
 SONODYNE 13 11 09

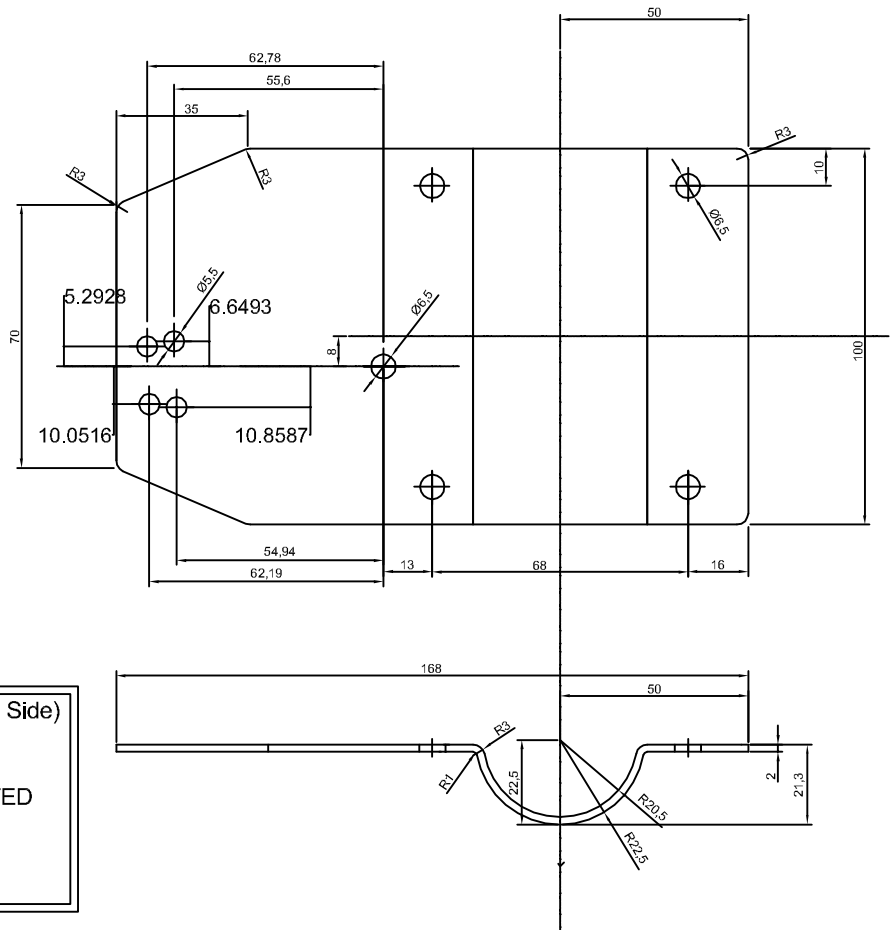
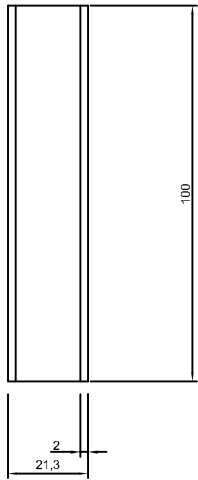

POLE PLATE for POLE MOUNT BKT.(Left Side)
 Model : ALIGN - 400 PM.
 MAT: 2 m.m. M.S. PLATE
 FINISH: BLACK \ WHITE POWDER COATED
 QTY: 1 no Per Set
 SONODYNE 13 11 09