



500Mbps Powerline Kit with AC Pass-through



Perfect for

- Transporting the Internet around the home
- Connecting PC's, TV's, gaming consoles, blu-ray players, TiVo and other networkable devices
- Streaming media and content to connected devices
- Areas where other electrical devices are kept as the same power point can be used

KEY FEATURES

- ⌚ Create a high-performance Internet connection throughout your home using the existing power line network
- ⌚ High-speed data rates of up to 500Mbps¹
- ⌚ 1 x 10/100 Ethernet ports for multiple wired network connections
- ⌚ In-built AC pass-through makes power points available for other uses
- ⌚ Noise filtering protects data signals from disruptions
- ⌚ Works out of the box - no setup required
- ⌚ Work across multi-phase power circuits
- ⌚ Power saving features
- ⌚ Compact casing designed specifically for power points in Australia and New Zealand. Allows the adjoining socket on a double point to be used as the compact casing design does not encroach on the adjoining power socket





SPECIFICATIONS

PACKAGE INCLUDES

- 2 x Powerline Adapters with AC Pass Through
- 2 x Ethernet Cables (RJ-45)
- Printed Quick Start Guide
- Warranty Card

MINIMUM SYSTEM REQUIREMENTS

- Modem Router
- Active Internet Connection
- Available Power Sockets
- Computer or network device with a free Ethernet port

MAIN CHIPSET

- Powerline: Atheros AR7420 chipset

STANDARDS

- Powerline: IEEE 1901/HomePlug AV
- Ethernet: IEEE 802.3 10/100 Mbps Auto MDI/MDIX
- Compliant to EuP

MODULATION SUPPORT

- Powerline: OFDM 4096/1024/256/64/16/8 QAM, QPSK, BPSK and ROBO

DATA TRANSFER RATE

- Up to 500Mbps over Powerline¹

RANGE

- Up to 300m over Powerline¹

SECURITY

- 128-bit AES Encryption
(enabled with Simple Connect button)

EXTERNAL CONNECTORS

- 1 x 10/100 Ethernet LAN port
- 1 x Reset button
- 1 x Security push button
- 1 x Filtered AC pass-through socket

LED INDICATORS:

- 1 x Bicolour Power LED
- 1 x Bicolour Powerline Link/Activity Status LED
- 1 x Bicolour Ethernet Link/Activity Status LED

POWERLINE FILTERING

- Filtering at frequency band 2MHz to 68MHz
- Filter characteristics: -25dB to -45dB

POWER SUPPLY

- AC 220-240V 50-60Hz

ENVIRONMENTAL

- Operating: 0°C to 40°C
- Non-Operating: -20°C to 70°C
- Operating: 10% to 90% Relative Humidity
(Non-Condensing)
- Non-Operating: 5% to 90% Relative Humidity
(Non-Condensing)

MEASUREMENTS

- Dimensions 56 mm x 112 mm x 47 mm
- Weight 155g

CERTIFICATIONS

- RCM
- SAA111557EA

500Mbps Powerline Kit with AC Pass-through

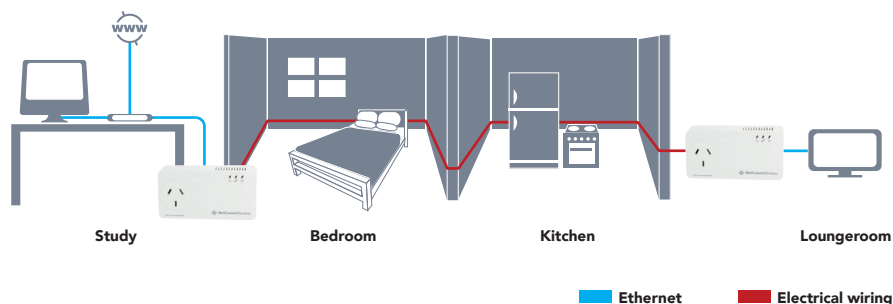

NetComm's 500Mbps Powerline Kit with AC Pass-through will give your home network the capacity to handle high bandwidth-intensive applications such as HD-TV, online gaming, multimedia and video streaming with plug and play simplicity.

An available power point is all you need to create a powerful high-speed Internet connection in any room of the house using your existing network of Powerline. The compact adapters are easy to setup simply connect and begin to use

HIGH SPEED POWERLINE

Ideal for moving the Internet and streaming media to any location throughout your house.

AC PASS THROUGH

The compact adapters are easily concealed behind furniture and feature built-in AC pass-through to free up your power points for other purposes.

THOUGHTFUL HOUSING DESIGN

When connected to power, the NP511 doesn't encroach on the neighbouring power socket.

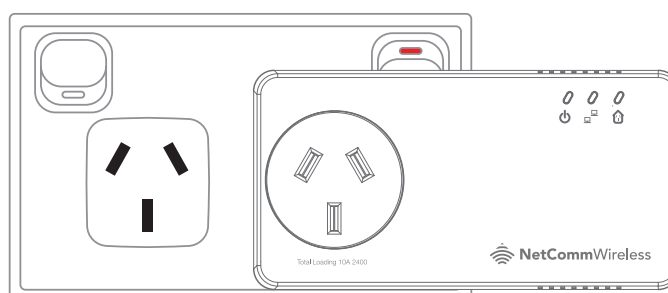

¹ Maximum throughput based on theoretical data rate. Actual data throughput will vary. Network conditions and environmental factors, including volume of network traffic, and network overhead, lower actual throughput rate



NetCommWireless

NETCOMM WIRELESS LIMITED

Head Office - 18-20 Orion Road, Lane Cove,
NSW 2066, Sydney, Australia ABN 85 002 490 486

E: sales@netcommwireless.com

www.netcommwireless.com