

PRO1351WP BLUETOOTH AUDIO WALL PLATE



CLASS D AUDIO AMPLIFIER WALL PLATE WITH BUILT-IN BLUETOOTH

Use the PRO1351WP to power in-ceiling speakers with the audio from any Bluetooth enabled device, or other source device such as computers, DVD players, and TVs! Creates a neat, clean solution for permanent audio installations that makes it perfect for entertaining areas, and even bedrooms

Perfect for upgrading existing wallplate amp modules with rear/in-wall power and audio connections! Add Bluetooth to your existing multi-room local in put amp.

The unique Decora-style wallplate design ensures a professional and clean installation without the need to loose or extra 'boxes' lying around! Great for indoor/outdoor speaker systems where simple and discrete convenience is paramount.

Ideal for use with:

- Mobile devices with Bluetooth audio
- DVD players
- TV's
- Indoor/Outdoor Speakers
- In-ceiling/in-wall Speakers

Features

- Bluetooth wireless audio receiver built-in
- Switch between Bluetooth or 3.5mm (line) inputs
- Discrete and compact Decora-style wall plate design
- Volume control
- Suitable for 4Ω, 6Ω and 8Ω speakers
- Speaker screw terminals handle wire sizes from 24 to 12 gauge
- Rear and front Power and Audio input connections for neat installation
- Includes Speaker Protection circuit

Specifications

- Audio Inputs: Bluetooth Receiver or stereo audio line level
- Bluetooth Receive Distance: 10 Metres
- Bluetooth Version: 3.0 EDR compliant
- Power Amplifier Type: Stereo Class-D
- Output power: 15W(RMS) per channel (@ RL=4 ohm)
- THD+N: 0.06 % (@ RL=8 ohm, f = 1 kHz)
- Minimum Load Resistance: 4 Ohm
- Power Source: 12 VDC/2A (included)

Model: PRO1351WP

Order Code: 01458314

Warranty: 12 months

Package contents:

- 1x** PRO1351WP wall plate
- 1x** User Quick Start Guide
- 1x** Power supply

Simple Connection

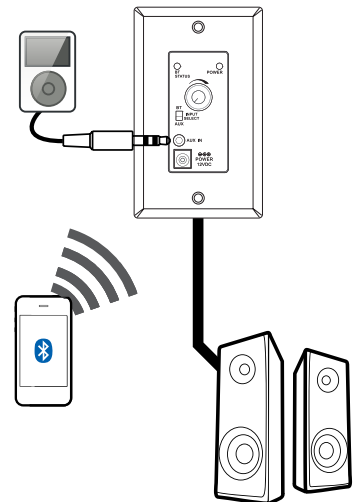

Send music from any Bluetooth enabled media device, phone, PC, or tablet. Alternatively, connect any audio player via the standard 3.5mm audio jack and alternate between Bluetooth or AUX with the flick of a switch.

The PRO1351 is amplified— so it connects straight to your speakers!

Also Available



Non wall-plate version— ideal for installing where volume control is not intended to be adjusted by end-users!

Model: PRO1351

Order Code: 01458312