



Plug & View



Motion & Audio  
Detection



Night Vision



2-Way Audio



Free EdiView Viewer App  
For iOS & Android Phones

**IC-3140W**

## 720p Wireless H.264 Day & Night Network Camera

The Edimax IC-3140W 720p wireless network camera is a versatile monitoring device ideal for monitoring your home, shop or factory during the daytime or at night. With Edimax Plug-n-View technology, no complicated setup is required and you can easily connect the camera to the cloud and monitor remotely from a smartphone, tablet or laptop.

The IC-3140W features two-way audio, a motion & audio detection system, built-in microphone & speaker and a MicroSD/SDHC card slot. Motion detection can be configured according to user-defined areas and additionally utilizes a passive infrared sensor (PIR). Motion and audio-triggered snapshots and recording ensure that you capture any illicit or suspicious activity and the wireless user interface allows for easy installation and monitoring.

### Plug-n-View for 24/7 Easy Remote Monitoring

Edimax Plug-n-View technology makes it easy for you to keep an eye on your yard, garage, shop, factory or other assets wherever you go. With Plug-n-View technology, you can connect your network camera to the cloud in a few simple steps and access it remotely with a smartphone, tablet, or computer no matter where you are.



EdiView



Free EdiView viewer app  
for iPhone & Android phones



### Night Vision

With a light sensor, image sensor and four infrared LEDs, the IC-3140W is well equipped to meet indoor security and surveillance needs - even in low-light and night-time conditions. And with automatic ICR (IR Cut Filter Removal), infrared light is filtered out during the day time (while allowed to pass at night) ensuring exceptional video color quality at all times.



4 IR LEDs Image Sensor & ICR



Light Sensor

# 720p Wireless H.264 Day & Night Network Camera

**IC-3140W**

## Motion Detection Triggered Snapshots & Recording

The powerful built-in motion detection system, with pre-defined detection regions and passive infrared (PIR) sensor, offers peace of mind that you will capture any illicit activity. The PIR sensor detects motion via infrared radiation caused by temperature changes and when motion is detected, the network camera will produce snapshots or video footage of the event immediately – storing the data on a MicroSD/SDHC card or sending it automatically via email or ftp.

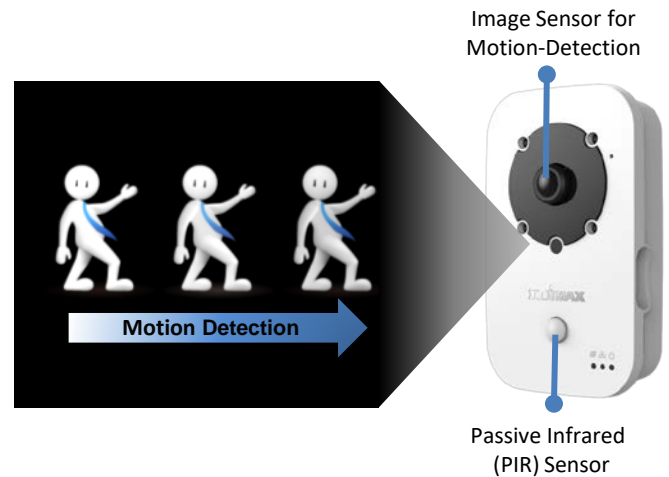

## Audio Detection Triggered Snapshots & Recording

The IC-3140W also features audio detection capabilities with a built-in microphone. When audio is detected, the network camera will take snapshots or video footage of the event immediately in the same manner as with motion-detection, and store the files locally on a MicroSD/SDHC card or send via email or ftp. Integrated audio offers a further level of security than motion-detection and visual imaging alone, providing critical real-time or post-event information about a situation, particularly in scenarios where events occur outside the camera's field of vision. The sounds of breaking windows, doors or anything else suspicious can still be registered even in situations where the event can't be seen.

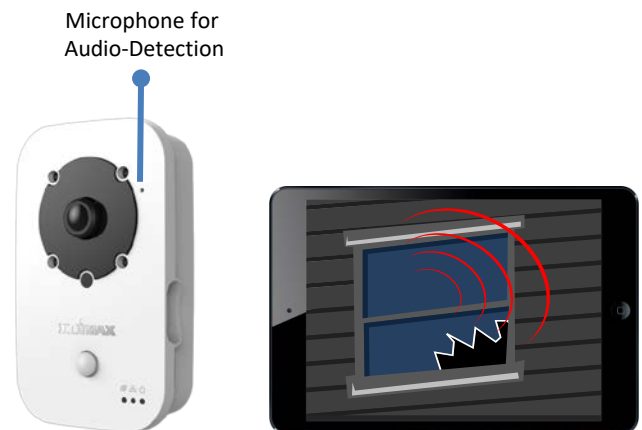

## Two-Way Audio

The network camera incorporates a speaker and microphone for two-way audio support, so you can remotely communicate at the camera's location or activate a deterrent alarm - a vital, cost-saving and potentially even life-saving additional security tool.



# 720p Wireless H.264 Day & Night Network Camera

IC-3140W

## High Quality Videos

The IC-3140W is built with a wide F2.0 lens which covers an impressive diagonal viewing angle of 78 degrees. With a megapixel CMOS sensor, the network camera is able to capture 720p (1280 x 720) videos at 24 frames per second.

**HD 720P**  
HIGH DEFINITION

1280 x 720

640 x 480



## MicroSD/SDHC Card Slot for Local Storage

A built-in MicroSD/SDHC card slot supports cards up to 64GB for local storage and backup.



## SOFTWARE FEATURES

- Easy remote monitoring via iPhone, iPad, Android, PC & Mac
- High-speed H.264 & MJPEG video compression
- Motion & audio detected snapshots or video to SD card, ftp or email
- Pre- & post-recording upon detected motion
- Viewer software to access 16 network cameras simultaneously
- Manual/scheduled/cycle recording

## Plug & View 3 Step Installation



### Keep an eye on what you care about the most

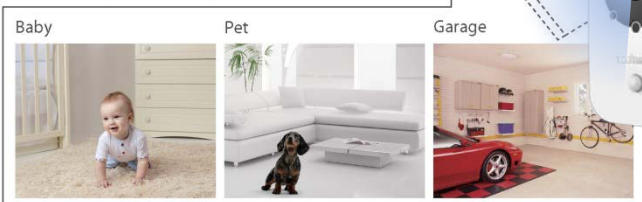

### Anywhere & anytime

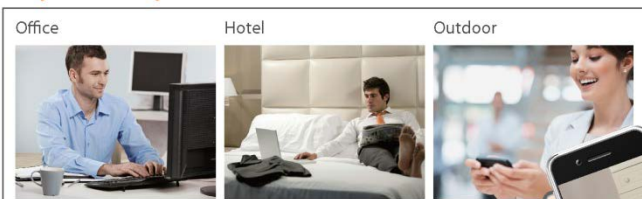

# 720p Wireless H.264 Day & Night Network Camera

**IC-3140W**

## TECHNICAL SPECIFICATIONS

| Function   | Management   | Interface   |
|--|--|---|
| <ul style="list-style-type: none"> <li>Easy remote monitoring via iPhone, iPad, Android, PC &amp; Mac</li> <li>78 degree diagonal viewing angle</li> <li>Supports dynamic DNS service</li> <li>IR filter embedded</li> <li>Built-in microphone and speaker for two-way audio</li> <li>Built-in Passive infrared (PIR) sensor for enhanced motion detection</li> <li>Motion/audio detection recording and alerts to MicroSD/SDHC card, email and FTP</li> <li>MicroSD/SDHC card slot for local storage</li> </ul> | <ul style="list-style-type: none"> <li>EdiView Finder (Windows/Mac)</li> <li>16-channel viewer</li> <li>Web management interface</li> <li>Firmware upgradable</li> <li>iPhone &amp; iPad viewer app</li> <li>Android viewer app</li> </ul> | <ul style="list-style-type: none"> <li>Ethernet (RJ-45) port</li> <li>Power jack</li> <li>Reset/WPS button</li> <li>Internal antenna</li> <li>Micro SD/SDHC card slot</li> <li>Passive infrared (PIR) sensor</li> <li>Light sensor</li> <li>Microphone</li> <li>Speaker</li> <li>IR LEDs: 4</li> <li>LED indicators: Internet, LAN/Wi-Fi, LNK/ACT, Power</li> </ul> |
| Video  | Video Settings   | Supported Protocols   |
| <ul style="list-style-type: none"> <li>High-speed H.264 &amp; MJPEG video compression</li> <li>1280 x 720 up to 24 fps</li> <li>640 x 480 up to 30 fps</li> <li>320 x 240 up to 30 fps</li> </ul>  | <ul style="list-style-type: none"> <li>Resolution: HD (1280 x 720), VGA (640 x 480), QVGA (320 x 240)</li> <li>Frame rate: 5, 10, 15, 20, 24 or 30 fps</li> </ul>  | <ul style="list-style-type: none"> <li>IPv4, HTTP, TCP, ICMP, RTSP, RTP, UDP, RTCP, SMTP, SNTP, FTP, DHCP, ARP, DNS, PPPoE</li> </ul>   |
| Standards  | RF Output Power  | IR LEDs   |
| <ul style="list-style-type: none"> <li>Fast Ethernet IEEE 802.3/802.3u</li> <li>Wireless IEEE 802.11b/g/n</li> </ul>   | <ul style="list-style-type: none"> <li>11b: 16dBm–18dBm</li> <li>11g: 14dBm–16dBm</li> <li>11n: 11dBm–13dBm</li> </ul>   | <ul style="list-style-type: none"> <li>IR LEDs for night illumination up to 15 feet</li> </ul>  |
| Memory   | Operating Conditions   | Power   |
| <ul style="list-style-type: none"> <li>8MB flash</li> <li>64MB SDRAM</li> </ul>  | <ul style="list-style-type: none"> <li>0–60°C</li> <li>Humidity: 20–80% RH (non-condensing)</li> </ul>   | <ul style="list-style-type: none"> <li>12V DC x 1A</li> </ul>   |
| Dimensions   | Weight   | Certifications  |
| <ul style="list-style-type: none"> <li>65 x 110 x 27.2 mm</li> </ul>   | <ul style="list-style-type: none"> <li>g (TBD)</li> </ul>  | <ul style="list-style-type: none"> <li>FCC, CE</li> </ul>   |

## APPLICATION DIAGRAM



## HARDWARE INTERFACE

