

# LED GU10 *TRI-CCT* GLOBE (6W)

- Input voltage: 176-264V AC
- Diffuser: plastic clear
- Housing: plastic & aluminium
- Heatsink: PBT
- LED chips: 10pcs SMD2835
- Tri-CCT (3000K/ 4000K/ 5000K)
- CCT switch on housing
- CRI: ≥80
- Power factor: ≥0.5
- Ambient temperature: -20 to 40°C
- Not suitable for dimming
- Suitable for 2 way switching
- Suitable for use with sensors

 20,000hr Lifetime	 60° Beam Angle	<b>IP20</b> Rated	<b>2YEAR</b> Replacement Warranty
---	--	----------------------	---

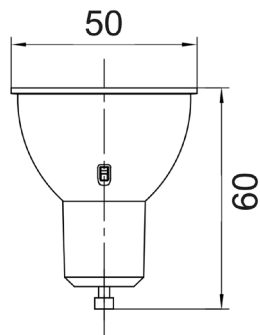

Part No.	Description	Lumens			Watt	Size	Box Weight	Box Size	Carton QTY
		3000K	4000K	5000K					
<b>GU10TRI1</b>	GLOBE LED GU10 6W TRI	432lm	495lm	605lm	6W	Ø50x60mm	0.45kg	5x6x7cm	1/10/100