

LED MR16 **TRI-CCT** GLOBE (6W)

- Input voltage: 12V AC/DC
- Diffuser: plastic clear
- Housing: plastic & aluminium
- Heatsink: PBT
- LED chips: 10pcs SMD2835
- Tri-CCT (3000K/ 4000K/ 5000K)
- CCT switch on housing
- CRI: ≥80
- Power factor: ≥0.5
- Ambient temperature: -20 to 40°C
- Not suitable for dimming
- Suitable for 2 way switching
- Suitable for use with sensors

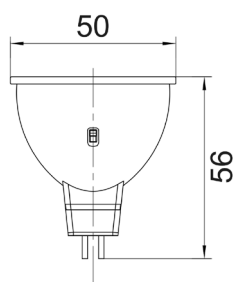

Part No.	Description	Lumens			Watt	Size	Box Weight	Box Size	Carton QTY
		3000K	4000K	5000K					
MR16TRI1	GLOBE LED MR16 6W TRI	432lm	495lm	605lm	6W	Ø50x56mm	0.05kg	5x5x6cm	1/10/100

Suggested Power Supplies:

BRAND	PART NO.	TYPE	IP RATING
LUXMAN	TPIPA12-50	Transformer	IP65
CLA		LED Driver (Constant Voltage)	IP20
CLA	TPDRV1	LED Driver (Constant Voltage)	IP20
CLA	TPIP12-12	LED Driver (Constant Voltage)	IP67
CLA	TPIP12-10	LED Driver (Constant Voltage)	IP67
CLA	CLA113011	LED Driver (Constant Voltage)	IP67
CLA	TPIP12-30	LED Driver (Constant Voltage)	IP67
CLA	TPIP12-100	LED Driver (Constant Voltage)	IP67
CLA		LED Driver (Constant Voltage)	IP67
CLA	TPIP12-200	LED Driver (Constant Voltage)	IP67
CLA		LED Driver (Constant Voltage)	IP67