

SeKi Universal remote control

Suitable for use with Sharp TV / LCD / LED / HDTV

3D LCD LED SMART TV LEARN

Thank you for choosing this remote control. Please insert batteries (2x AAA) and test the remote control with your device. This remote control can control 99% of Sharp brand models without manual setup. If some keys do not work, please use the following options for manual setup. The "SeKi suitable for Sharp" retains the settings when changing the battery.

Manual setup options

A. Enter code

3-digit code list: 001.002.003.004.005.006. 007.008.009.010.011. 012.013.014.15.016.017.018.019.020.021.022.023.024

A1. Hold down the [MUTE] and [POWER] buttons, after 3 seconds the LED lights up.

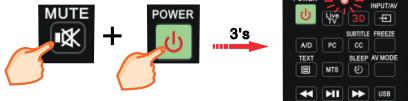

A2. Release the buttons and enter the three-digit code from the code list above. When the code entry is complete, the LED goes out. If you have entered an incorrect code, the LED will remain on. In this case, check the entered code again and repeat the entry.

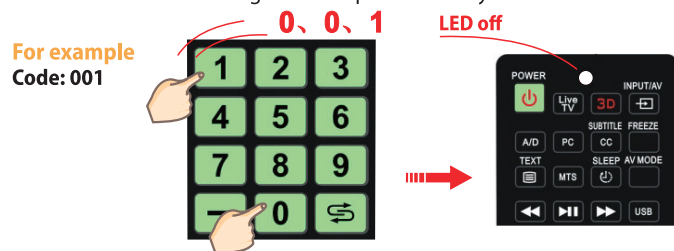

A3. Please try to use the remote control. If it doesn't work well, try other codes: [002], [003], [004], ...

NOTE: To end the setting process, please press the button [MUTE].

B. Show used code

Check which code the remote control is currently using.

B1. Press the button [MUTE] first, then press [POWER] and hold both. The LED lights up after 3 seconds. Let go of the buttons.

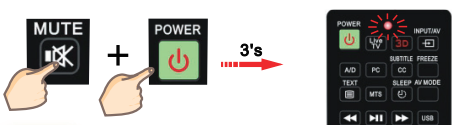

B2. Enter the following sequence of numbers with the numeric keys [9] [9] [0]. The LED flashes twice and then goes out.

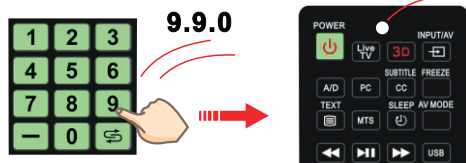

B3. To get the number for each digit of the code, press the buttons [1], [2], [3] - e.g. : by pressing [1] the LED starts to flash. It flashes in the number of the first code digit. If the code number is [0], the LED does not flash. Repeat the process for all three digits using the [1], [2], [3] buttons.

For example
Code: 005

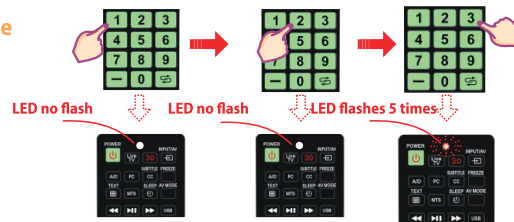

C. Learning function

NOTE: If no button is pressed within 25 seconds during the learning process, the learning mode is exited without saving.

IMPORTANT: suitable for infrared remote controls (IR), not suitable for Bluetooth or radio remote controls.

C1. First press and hold the button [MUTE] and simultaneously press [VOL +] for about 5 seconds. The LED lights up. Release both buttons. The learning mode is now active.



C2. Point the original remote control at the SeKi. The distance should be about 1-3 cm. Avoid strong interference light from surrounding lamps or the sun.

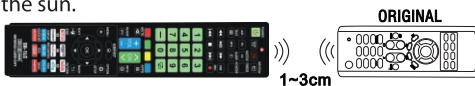

C3. Press and hold the button you want to transfer on the original remote. The LED of the SeKi remote control flashes after the information has been received. Let go of the button. Press the corresponding button on the SeKi remote control. The LED display flashes twice and lights up continuously. Repeat step **C3** to teach all other buttons.



C4. When you have learned all the keys, hold down the [MUTE] key first. Then press the [VOL -] button. The settings are saved and the LED goes out.

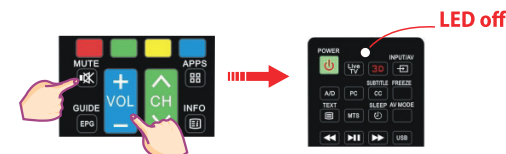

D. OneKey Duplication

D1. Insert batteries in both SeKi suitable for Sharp remote controls.

Remote control A is the already trained SeKi

Remote control B is the "empty" SeKi

D2. Point **remote control A** at **remote control B**. The distance should be approx. 1-3 cm. Avoid strong interference light from surrounding lamps or the sun.



D3. Remote control B First press and hold the button [MUTE] and simultaneously the button [3] longer than 3 seconds. The LED lights up. Release both buttons. The copy mode is now active.

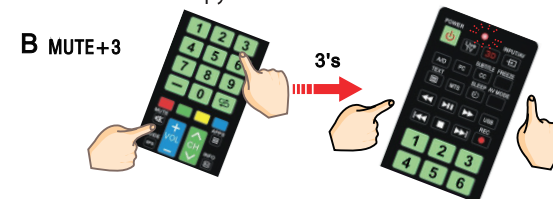

NOTE: Make sure that the remote controls point towards each other as in D2.

D4. Remote control A First press and hold the button [MUTE] and at the same time the button [1] for approx. 3 seconds. Release both buttons when the LED lights up. If both LEDs flash, the copying process is running. As soon as both LEDs flash slowly three times and then go out, the copying process is finished.

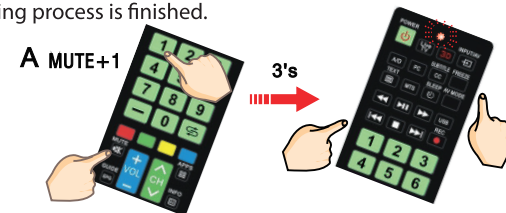

D5. Check the functionality of the **remote control B**. If some of the buttons do not work, please repeat steps D2-D4.

NOTE: To end the setting process prematurely, please press the button [MUTE] and [VOL -].



WEEE-Reg.-Nr. DE 60722497

www.my-seki.com