

# McLELLAND®

## WIRELESS SPEAKER KIT WITH SUBWOOFER OUTPUT

Please read this user's guide before using your new speaker kit.

### User's Guide

UWA-S



### Package Contents

- Transmitter
- 9V AC Adapter
- Stands (2)
- User's Guide
- Receiver
- 15V AC Adapter
- 6-foot speaker wire (2)

### Features

- 2.4GHz digital wireless link provides crystal-clear audio signals.
- 34-channel selection.
- Up to 100 feet (30.5m) operation distance between transmitter and receiver (line of sight).

### Install the Transmitter

1. Make sure your amplifier is off. Connect the transmitter to your amplifier's speaker output terminals with the provided 6-foot speaker wire, matching polarities. Or connect your transmitter to the amplifier's RCA output ports with RCA cables (not included).

2. Connect the supplied AC adapter (9V, 200mA) to the DC IN 9V jack, then plug it into a standard household outlet.

### Install the Receiver

1. Connect the rear speakers to the receiver with speaker wires, matching polarities.
2. Connect the supplied AC adapter (15V, 4A) to the DC IN 15V jack, and then plug it into a standard household outlet.

Note:

- Make sure the exposed tips of the speaker wires do not touch each other, and make sure they are fully inserted into the terminals.
- This speaker kit is designed for connecting to your amplifier surround speaker terminals only.
- For speaker wires that have proprietary connectors, you may need to strip the end of the wires to allow connection to the receiver. However, check with the speaker manufacturer before doing this, as it may void the warranty.
- When the RCA cables are connected, audio input from the speaker terminal will be mixed.
- Unplug the AC adapters from the AC outlet before unplugging it from the transmitter or receiver.
- Use the supplied AC adapters only. Using an AC adapter not designed for this product may cause damage.

### Place the Transmitter and Receiver

The transmitter and receiver must be placed within 100 feet for proper operation. They can be placed horizontally on a flat surface, vertically in the provided stands, or mounted on a wall using the mounting holes on the bottom.

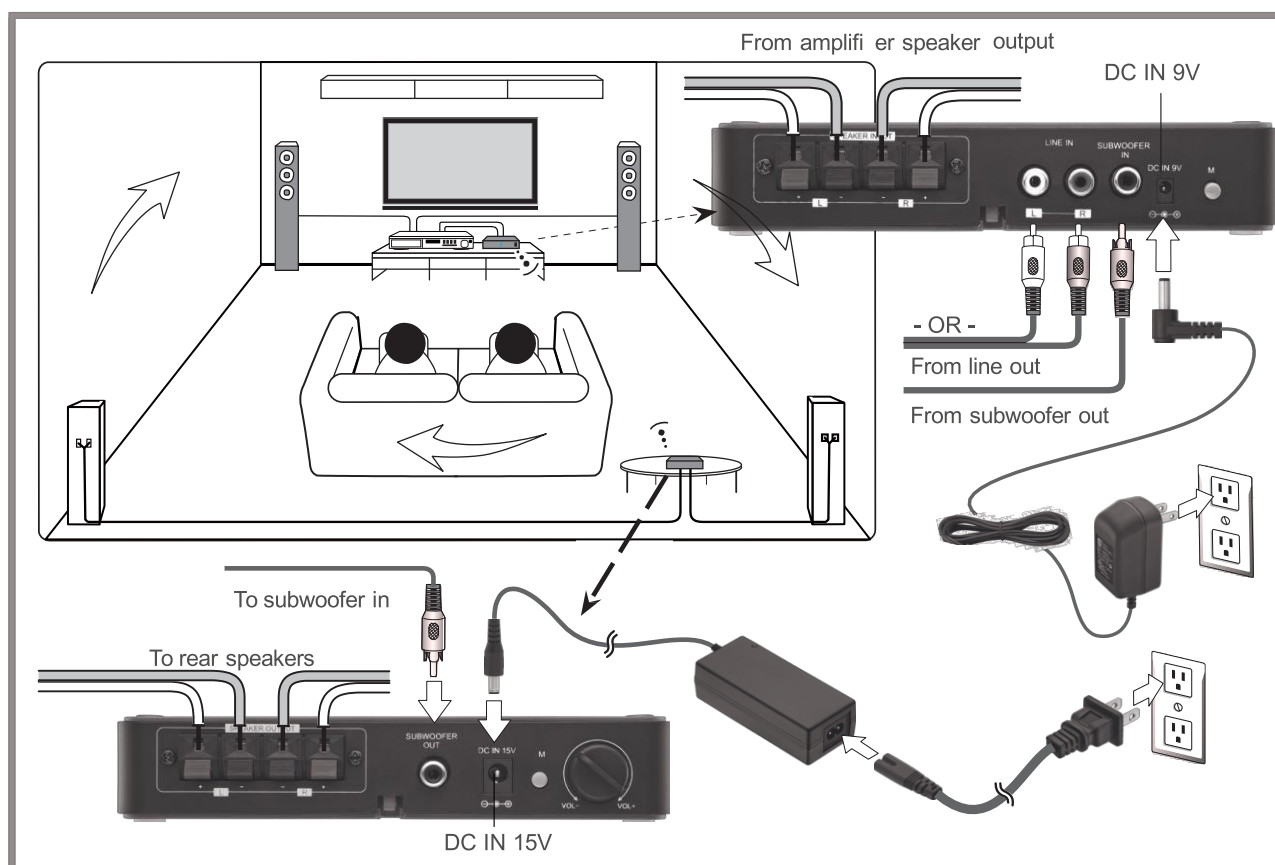

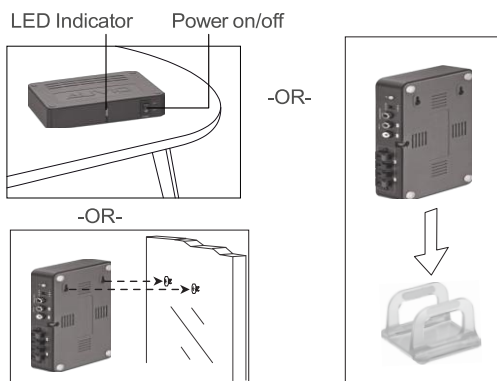

Note :

If you need to mount the receiver on a wall, install it against the wall in such a way that the ventilation slots are not blocked.

To optimize the reception performance, place the transmitter and receiver in the same orientation.

## Use Your Speaker Kit

1. Once the AC adapters are connected, the receiver LEDs light green. The speaker kit enters standby mode.
2. Turn on your amplifier and then play the audio or video source through your amplifier.
3. When an audio signal is detected by the transmitter and the transmitter signal is detected by the receiver, the speaker kit will automatically go into active mode. The transmitter and receiver LEDs will both turn blue.

Note : After powering on, if there is no signal input within 17 minutes , the speaker kit enters standby mode.

## Change the Channel

If you experience any interference, press and hold the M button on both units. The units will then automatically pair.



## Adjust the Volume Balance

1. Power on the transmitter and receiver, and then turn on the amplifier and adjust it to your normal listening level.
2. Adjust the receiver's VOL +/- control to balance the front and rear speaker sound level. This step is only necessary during first-time installation of the speaker kit with your system.
3. After balance setup, simply use the volume control on your amplifier to adjust speaker volume during playback.



## Optimize Your Surround Sound

Many surround-sound systems let you adjust the delay between the front and rear speakers. To optimize your setup, adjust the rear speaker delay response by about 20 milliseconds.

## Specifications

Audio Output Level .....	Subwoofer out: 2 V
.....	Speaker out: 25W (Load at 4Ω )
Input Sensitivity .....	Line in: 1V
.....	Subwoofer in: 2 V
.....	Speaker in: 10V

Frequency Response .....	Subwoofer: 20Hz-200Hz
.....	Speaker: 20Hz-20kHz
Audio Distortion .....	Subwoofer: <1%
.....	Speaker: <10%
Signal to Noise Ratio .....	>80dB
Operation Distance .....	100 ft (30.5m)
Dimensions (H×W×D) .....	6.9 X 3.9 X 1.6 inch
.....	175×100×32mm
Weight .....	3.3 lb. (1.5kg)

Specifications are subject to change and improvement without notice. Actual product may vary from the images found in this document.