

Drypower Gel

DEEP CYCLE GEL TYPE SEALED LEAD ACID BATTERY

12GB24C (12V 24Ah)

SPECIFICATIONS

Nominal Voltage (V) 12V

Nominal Capacity

20 hour rate (1.2A to 10.50V)	24Ah
5 hour rate (4.08A to 10.20V)	20.4Ah
1 hour rate (13.2A to 9.60V)	13.2Ah
1C (24A to 9.60V)	12.8Ah

Weight Approx. 9.5kg (20.9lbs)

Internal Resistance (@1kHz) Approx. 7mΩ

Maximum Discharge Current

For 5 seconds 360A

Charging Methods @25°C (77°F)

Cycle Use:

Charging Voltage	13.80V to 14.40V
Coefficient -5.0mV/°C/Cell	
Maximum Charging Current	7.2A

Standby Use:

Float Charging Voltage	13.50V to 13.80V
Coefficient -3.0mV/°C/Cell	

Operating Temperature Range

Charge	-15°C (5°F) to +40°C (104°F)
Discharge	-15°C (5°F) to +50°C (122°F)
Storage	-15°C (5°F) to +40°C (104°F)

Charge Retention (Shelf Life) @20°C (68°F)

1 month	92%
3 months	90%
6 months	80%

Case Material ABS

Terminal F3



DIMENSIONS

mm (inch)

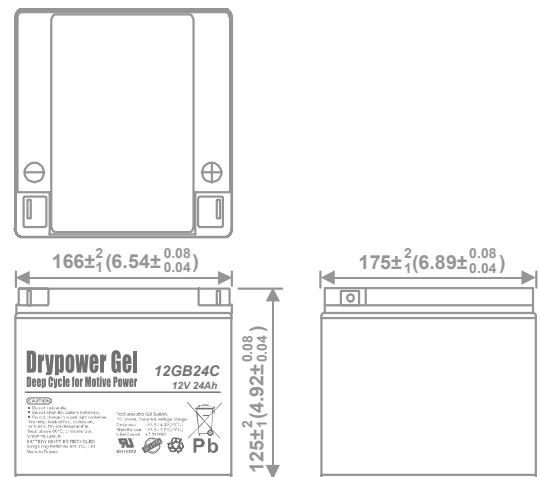
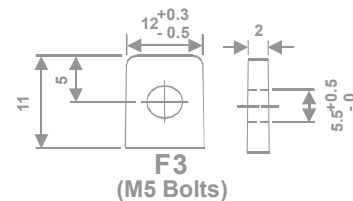

Discharge Time VS. Discharge Current (25°C)

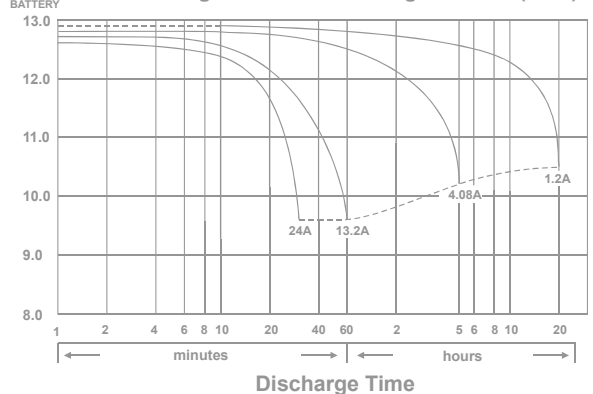

Effect of Temperature on Capacity 25°C (77°F)

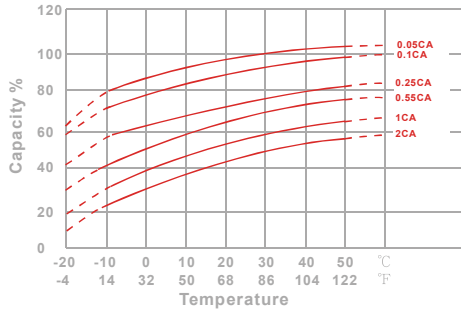

Capacity Retention Characteristic

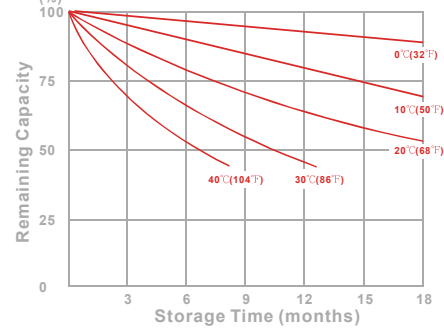

Trickle (or float) Service Life

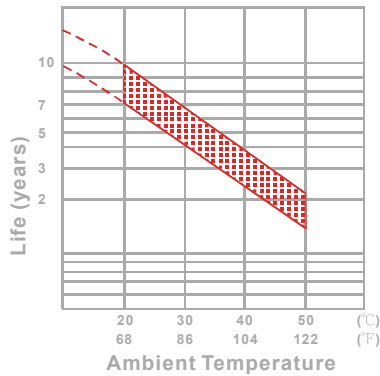

Cycle Service Life

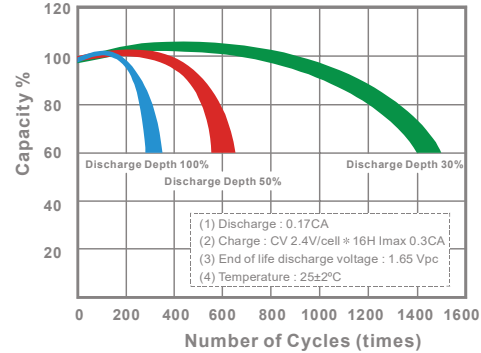

- PERFORMANCE DATA

Discharge Rates in Watts to Various End Voltages at 25°C (77°F)

Time	End Voltage	1.85V	1.80V	1.75V	1.70V	1.67V	1.65V	1.60V
5	min	795	903	976	1018	1030	1044	1046
10	min	547	608	637	660	687	700	731
15	min	402	463	492	520	531	541	556
30	min	213	246	271	287	291	296	302
60	min	139	153	164	173	176	179	183
120	min	92.7	100	105	109	110	112	114
180	min	69.1	73.2	75.5	77.4	78.1	78.8	79.6
240	min	56.3	59.7	61.2	62.4	62.8	63.3	63.9
300	min	48.9	51.0	51.9	52.6	52.8	53.1	53.5
600	min	27.6	29.1	30.3	31.1	31.3	31.5	31.8
1200	min	15.2	15.7	16.1	16.4	16.5	16.6	16.7

- Discharge Rates in Amperes to Various End Voltages at 25°C (77°F)

Time	End Voltage	1.85V	1.80V	1.75V	1.70V	1.67V	1.65V	1.60V
5	min	67.0	79.6	88.5	94.2	95.9	97.7	99.5
10	min	47.2	53.1	56.0	58.7	60.8	62.5	65.6
15	min	32.6	38.2	42.1	45.3	46.5	47.4	48.7
30	min	18.2	21.4	23.7	25.4	25.9	26.6	27.1
60	min	14.3	15.1	15.5	15.9	16.0	16.2	16.4
120	min	8.41	8.79	9.04	9.27	9.34	9.40	9.49
180	min	5.75	6.06	6.29	6.51	6.58	6.64	6.73
240	min	4.89	5.17	5.36	5.52	5.56	5.60	5.67
300	min	4.15	4.38	4.56	4.70	4.73	4.77	4.82
600	min	2.21	2.36	2.47	2.56	2.58	2.61	2.64
1200	min	1.17	1.24	1.29	1.33	1.34	1.36	1.38

All data on the spec. sheet is an average value:

The tolerance range : $X < 6\text{min} (+15\% \sim -15\%)$, $6\text{min} \leq X < 10\text{min} (+12\% \sim -12\%)$, $10\text{min} \leq X < 60\text{min} (+8\% \sim -8\%)$, $X \geq 60\text{min} (+5\% \sim -5\%)$

Performance may vary depending on application. All specifications are correct at time of creation. All specifications and operation conditions contained in this datasheet are subject to change or improvement without prior notice to the user. This data is for evaluation purposes only. No guarantee is intended or implied by this data. For clarification and updated information, please contact us.