

## Dimensions

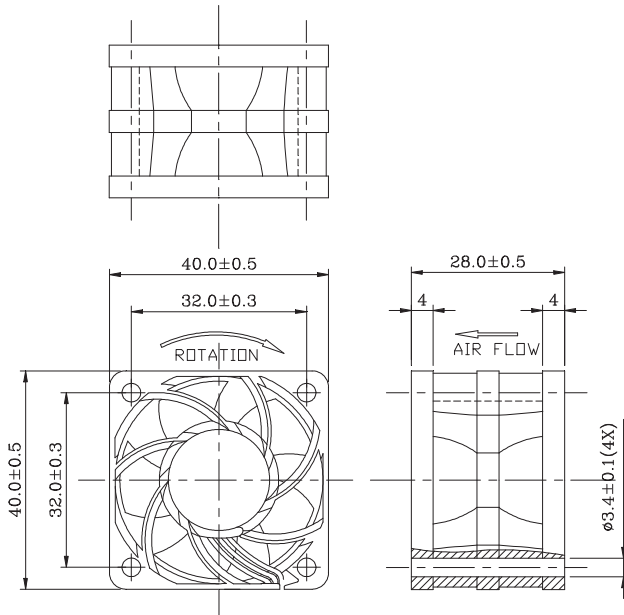

Air exhaust over struts. Rotational direction CCW looking at rotor.

Brushless DC Motor	Bearing Type
Weight: 30g Impedance protected Lead wire UL 1095 AWG 28	Ceramic

\* All fans are with electronic protection against reverse polarity. The fan only operates when the polarity is correct.

## Performance Curves

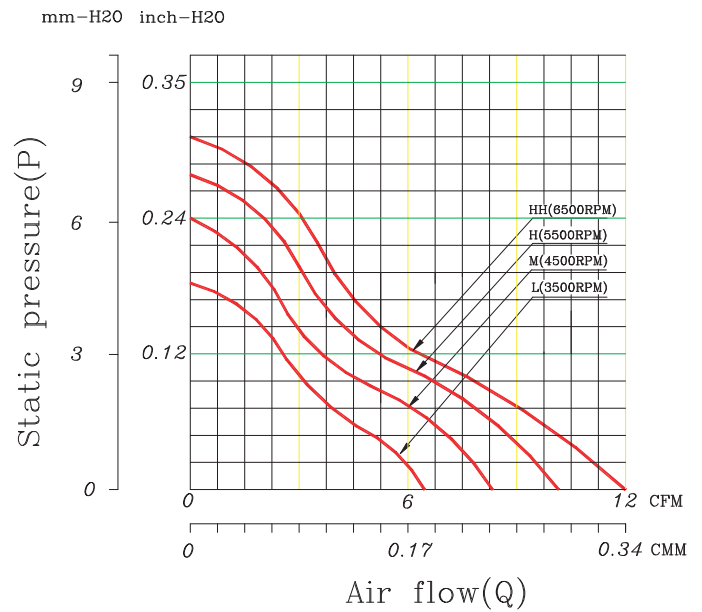

Function Options	
<input checked="" type="checkbox"/> Frequency Generator	<input checked="" type="checkbox"/> Auto Restart

- \* Please contact us for PWM function availability.
- \* Please contact us for IP55 availability.
- \* Safety Approval: CE, UL, TUV

## Specifications

Model	Rated Voltage (VDC)	Rated Current (Amp)	Input Power (Watts)	Nominal Speed (RPM)	Airflow (CFM)	Static Pressure (inch -H2O)	Noise Level (dBA)
FAN4028C5HH	5	0.33	1.65	6500	12.03	0.31	30.00
FAN4028C5H	5	0.25	1.25	5500	10.16	0.28	26.00
FAN4028C5M	5	0.17	0.85	4500	8.33	0.24	22.00
FAN4028C5L	5	0.11	0.55	3500	6.46	0.19	19.00

\* Specifications are subject to change without prior notice.

\* Check with your distributor for models available.

### Dimensions

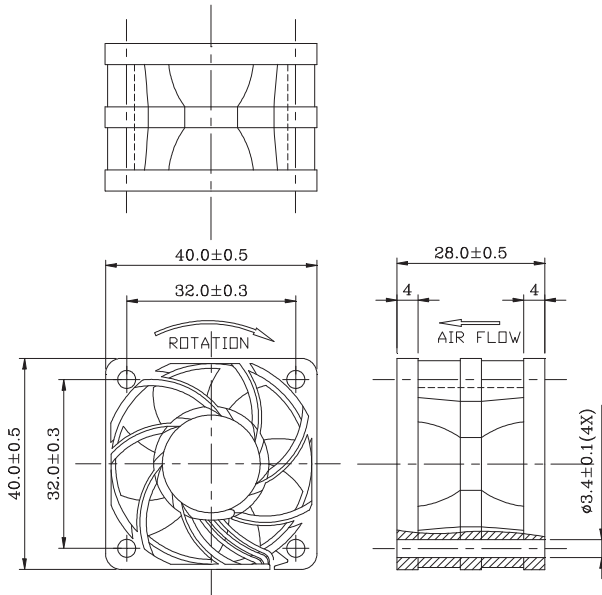

Air exhaust over struts. Rotational direction CCW looking at rotor.

Brushless DC Motor	Bearing Type
Weight: 30g Impedance protected Lead wire UL 1095 AWG 28	Ceramic

\* All fans are with electronic protection against reverse polarity. The fan only operates when the polarity is correct.

### Performance Curves

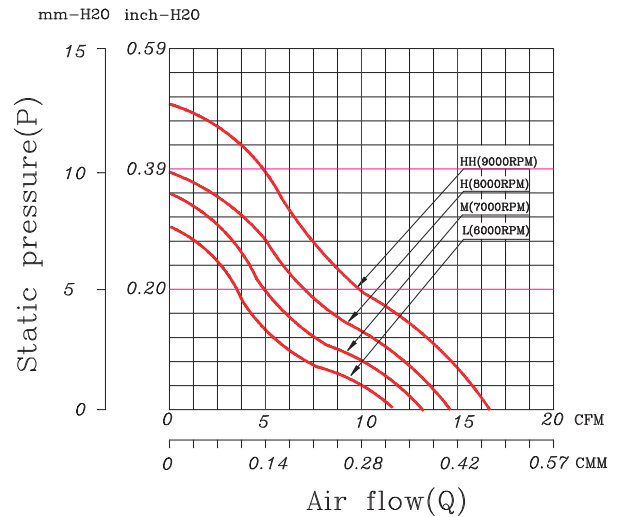

Function Options	
<input checked="" type="radio"/> Frequency Generator	<input checked="" type="radio"/> Auto Restart

- \* Please contact us for PWM function availability.
- \* Please contact us for IP55 availability.
- \* Safety Approval: CE, UL, TUV

### Specifications

Model	Rated Voltage (VDC)	Rated Current (Amp)	Input Power (Watts)	Nominal Speed (RPM)	Airflow (CFM)	Static Pressure (inch -H2O)	Noise Level (dBA)
FAN4028C12HH	12	0.31	3.72	9000	16.65	0.50	41.00
FAN4028C12H	12	0.24	2.88	8000	14.80	0.39	36.00
FAN4028C12M	12	0.19	2.28	7000	12.95	0.35	33.00
FAN4028C12L	12	0.14	1.68	6000	11.10	0.30	29.00
FAN4028C24HH	24	0.24	5.76	9000	16.65	0.50	41.00
FAN4028C24H	24	0.16	3.84	8000	14.80	0.39	36.00
FAN4028C24M	24	0.12	2.88	7000	12.95	0.35	33.00
FAN4028C24L	24	0.10	2.40	6000	11.10	0.30	29.00

\* Specifications are subject to change without prior notice.

\* Check with your distributor for models available.