

Adapter/Junction Box for Surveillance Cameras

Model: MB1051

Aluminium adapter/junction box used as a spacer or as connector for corner & pole mounts.

Model	MB1051
Materials	Aluminium
Dimensions	Ø110 x 34mm
Pipe Thread	M20 (G1 1/2")
Operating Conditions	-40° ~ 60°C / 90% RH (max)
Load Bearing Capacity	1.00kg
Weather Resistance	Yes
Weight	0.18kg



Bracket Compatibility

This bracket is compatible with the following cameras from VIP Vision and/or Securview Victory Series.



VSIP4MPVDMINIIRC Series,
VSIP2MPVDMINIIRC3.6



VSCVI2MPVDIR

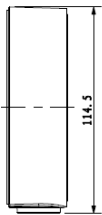
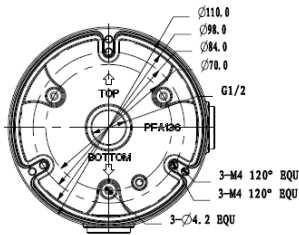
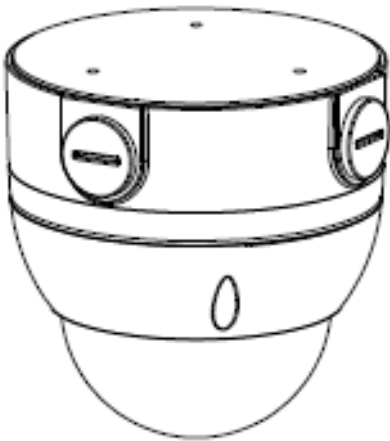

Additional camera brackets, adapters, junction boxes or connectors may be required for camera compatibility. Please see full bracket compatibility reference for more detail.

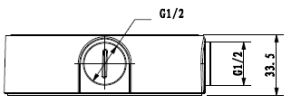

Your professional CCTV surveillance dealer: